



Data Source: Iowa Dept. of Education, [Proficiency by District](#)

Notes: Assessment proficiency data includes Partial Academic Year (PAY) students who participated in the ISASP or the Dynamic Learning Maps (DLM) alternate assessment. Remote testing results are not included. Excludes English learners who are in their first or second year enrolled in the U.S. The 2018-19 column does not include 9th grade data as this grade was not a state required testing/reporting grade during that year.

English Language Arts Data Charted by Grade

English Language Arts Scores by Grade (Current Year)

Grade	2018-19	2019-20	2020-21	2021-22	2022-23	2023-24
3rd	52.0	No data	47.8	84.6	86.4	67.7
4th	72.7	No data	71.4	86.4	80.8	71.4
5th	79.4	No data	57.7	61.9	86.4	80
6th	51.4	No data	74.1	48.0	77.3	83.3
7th	60.0	No data	78.1	59.3	53.8	77.3
8th	64.3	No data	77.8	87.1	76	75
9th	No data	No data	66.7	56.3	90.9	76
10th	66.7	No data	76.7	63.0	69.4	90
11th	70.0	No data	57.9	47.1	65.5	67.6

3rd Grade	4th Grade	5th Grade
67.7	71.4	80.0
State avg: 64.2	State avg: 72.9	State avg: 69.0
6th Grade	7th Grade	8th Grade
83.3	77.3	75.0
State avg: 74.5	State avg: 77.3	State avg: 77.5
9th Grade	10th Grade	11th Grade
76.0	90.0	67.6
State avg: 74.9	State avg: 73.8	State avg: 70.2

Note:
 - Data was not collected for the 2019-20 school year.
 - To compare simple cohort (essentially the same students across time) please read the table in a diagonal fashion across the years. To compare cross sectional cohort (same grade over time) please read across each row.

Math Scores by Grade (Current Year)

Math Data Charted by Grade

3rd Grade	4th Grade	5th Grade
83.9	66.7	84.0
State avg: 76.3	State avg: 72.7	State avg: 70.7
6th Grade	7th Grade	8th Grade
79.2	81.8	78.6
State avg: 71.1	State avg: 69.9	State avg: 73.2
9th Grade	10th Grade	11th Grade
64.0	73.3	62.2
State avg: 63.3	State avg: 66.0	State avg: 65.7

Grade	2018-19	2019-20	2020-21	2021-22	2022-23	2023-24
3rd	56.0	No data	87.0	80.8	90.9	83.9
4th	54.5	No data	76.2	86.4	92.3	66.7
5th	85.3	No data	73.1	71.4	95.5	84
6th	73.0	No data	59.3	72.0	86.4	79.2
7th	56.7	No data	68.8	63.0	69.2	81.8
8th	82.1	No data	66.7	80.6	76	78.6
9th	No data	No data	48.1	46.9	60.6	64
10th	58.3	No data	50.0	40.7	66.7	73.3
11th	53.3	No data	36.8	29.4	55.2	62.2

Note:
 - Data was not collected for the 2019-20 school year.
 - To compare simple cohort (essentially the same students across time) please read the table in a diagonal fashion across the years. To compare cross sectional cohort (same grade over time) please read across each row.

Science Data Charted by Grade

Science Scores by Grade (Current Year)

Grade	2018-19	2019-20	2020-21	2021-22	2022-23	2023-24
5th	64.7	No data	50	66.7	81.8	60
8th	39.3	No data	55.6	64.5	68	60.7
10th	45.9	No data	53.3	40.7	72.2	70

5th Grade	8th Grade	10th Grade
60.0	60.7	70.0
State avg: 59.6	State avg: 65.5	State avg: 59.5

Note:
 - Data was not collected for the 2019-20 school year.
 - To compare simple cohort (essentially the same students across time) please read the table in a diagonal fashion across the years. To compare cross sectional cohort (same grade over time) please read across each row.



Year: 2023

(1)

* All of the data on this page is gathered from the same graduating class of the year chosen

Postsecondary Intentions Compares AEA Average to School District Average

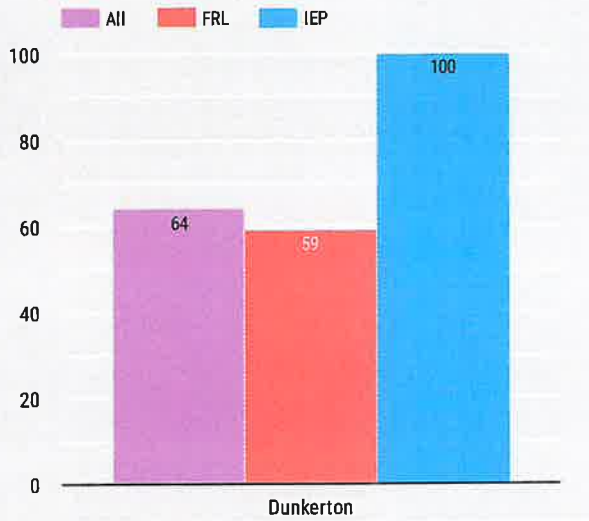

AEA All Average	AEA FRL Average	AEA IEP Average
73	62	44

1st Year Enrollment Compares AEA Average to School District Average

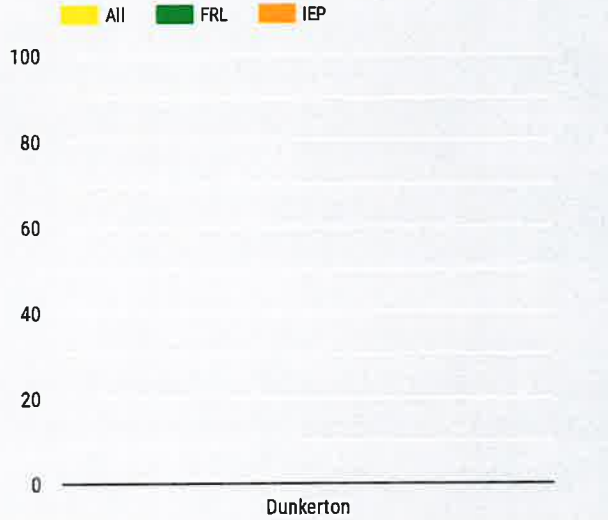

AEA All Average	AEA FRL Average	AEA IEP Average
0	0	0

Exception: Any data that is shown as 0% for the year of 2020, is related to either no data submitted or data inconsistencies that COVID-19 had an affect on.

Percentage of Students Enrolled in Public Postsecondary Taking at Least One Remedial/Developmental Course.

ENGLISH

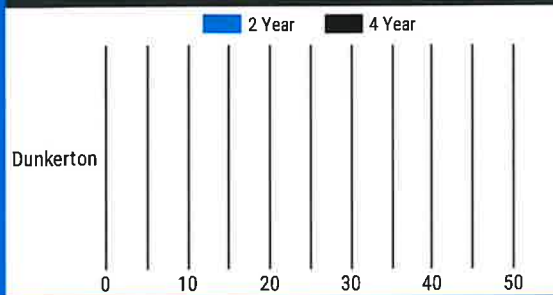

MATH

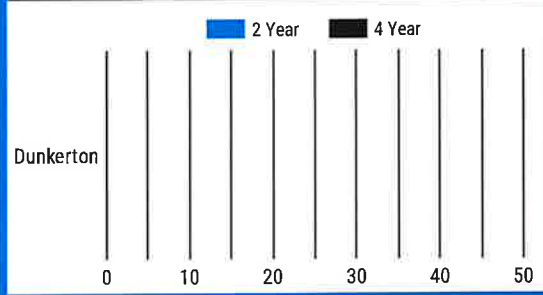

AEA English 2 Year
0

AEA Math 2 Year
0

AEA English 4 Year
0

AEA Math 4 Year
0

Percentage of FAFSA Completed

57.6

Your School

62.7

AEA

Exception: Any data that is missing would mean that data is not available.

Percent Proficient Subgroup Report

Note: The percentages below include student performance results from the ISASP and where applicable, student performance results from the Alternate Assessment. Thus, these results might be different from proficiency data from Iowa Testing which only includes ISASP student performance data. Source of these data is from the EdInsight APR 4.2 report.



jkremer@centralriversaea.org

ELA (From ELA Data Tab)

[Information regarding this report](#)

All Students

SubgroupSelect

Grade	Subgroup	Percent of students who are proficient or advanced					
		2019	2020	2021	2022	2023	2024
03	All Students	50		44	85	86	63
04	All Students	69		68	86	81	73
05	All Students	80		58	62	83	80
06	All Students	51		71	46	78	85
07	All Students	60		77	58	52	78
08	All Students	64		78	84	73	75
09	All Students	59		71	56	91	73
10	All Students	66		75	61	68	87
11	All Students	69		60	47	67	68

Math (From Math Data Tab)

All Students

Subgroup Select

Grade	Subgroup	Percent of students who are proficient or advanced					
		2019	2020	2021	2022	2023	2024
3	All Students	58		80	81	91	79
4	All Students	52		73	87	92	68
5	All Students	86		73	71	96	84
6	All Students	73		58	69	86	77
7	All Students	56		69	61	65	79
8	All Students	82		67	78	74	79
9	All Students	57		51	47	60	62
10	All Students	57		47	43	68	71
11	All Students	52		37	29	54	61

Science
 (From Science Data Tab)
Subgroup Select
 All Students

Grade	Subgroup	Percent of students who are proficient or advanced					
		2019	2020	2021	2022	2023	2024
05	All Students	65		50	67	79	60
08	All Students	40		56	63	65	61
10	All Students	46		50	39	70	68

ID	2016-19 (RSASP)				2020-2021 (RSASP)				2021-2022 (RSASP)				2022-2023 (RSASP)				2023-24 (RSASP)					
	Highly Proficient	Proficient	Advanced	Not Yet Proficient	Highly Proficient	Proficient	Advanced	Not Yet Proficient	Highly Proficient	Proficient	Advanced	Not Yet Proficient	Highly Proficient	Proficient	Advanced	Not Yet Proficient	Highly Proficient	Proficient	Advanced	Not Yet Proficient		
09	19	15	43%	1	3%	16	50%	17	61%	9	32%	2	7%	24	65%	10	32%	18	58%	3	10%	
09	11	3	20%	1	7%	8	67%	10	71%	4	29%	0	0%	17	88%	3	25%	7	58%	2	17%	
09	8	12	60%	0	0%	8	40%	5	50%	5	36%	2	14%	7	85%	7	37%	11	58%	1	5%	
09	NA	NA	NA	NA	NA	NA	NA	NA	NA	NA	NA	NA	NA	NA	NA	NA	NA	NA	NA	NA	NA	NA
09	NA	NA	NA	NA	NA	2	100%	0	0%	0	0%	0	0%	NA	NA	NA	NA	NA	NA	NA	NA	NA
10	0	0	0%	0	0%	0	0%	2	100	0	0%	0	0%	NA	NA	NA	NA	NA	NA	NA	NA	NA
10	0	1	100%	0	0%	0	0%	0	0%	0	0%	0	0%	NA	NA	NA	NA	NA	NA	NA	NA	NA
10	NA	NA	NA	NA	NA	1	100%	0	0%	1	100%	0	0%	NA	NA	NA	NA	NA	NA	NA	NA	NA
10	2	50%	0	0%	3	75%	0	0%	0	0%	1	23%	0	0%	0	0%	1	100%	0	0%	0	0%
10	17	57%	40%	1	3%	14	56%	15	60%	8	32%	2	8%	23	88%	9	30%	18	60%	3	10%	
10	NA	NA	NA	NA	NA	NA	NA	NA	NA	NA	NA	NA	NA	NA	NA	NA	NA	NA	NA	NA	NA	NA
10	19	15	43%	1	3%	16	50%	17	61%	9	32%	2	7%	24	65%	10	32%	18	58%	3	10%	
10	7	50%	0	0%	4	27%	11	73%	4	27%	2	14%	1	9%	9	82%	1	9%	8	67%	4	33%
10	12	8	38%	1	5%	12	71%	13	62%	7	33%	1	5%	15	55%	2	11%	14	74%	3	10%	
10	NA	NA	NA	NA	NA	NA	NA	NA	NA	NA	NA	NA	NA	NA	NA	NA	NA	NA	NA	NA	NA	NA
10	NA	NA	NA	NA	NA	NA	NA	NA	NA	NA	NA	NA	NA	NA	NA	NA	NA	NA	NA	NA	NA	NA
10	19	15	43%	1	3%	16	50%	17	61%	9	32%	2	7%	24	65%	10	32%	18	58%	3	10%	
10	2	100%	0	0%	0	0%	0	0	0%	0	0%	0	0%	0	0%	0	0%	3	75%	1	25%	
10	17	52%	45%	1	3%	14	47%	15	58%	9	35%	2	8%	23	86%	7	26%	17	63%	3	11%	
10	NA	NA	NA	NA	NA	NA	NA	NA	NA	NA	NA	NA	NA	NA	NA	NA	NA	NA	NA	NA	NA	NA
10	NA	NA	NA	NA	NA	NA	NA	NA	NA	NA	NA	NA	NA	NA	NA	NA	NA	NA	NA	NA	NA	NA
10	NA	NA	NA	NA	NA	NA	NA	NA	NA	NA	NA	NA	NA	NA	NA	NA	NA	NA	NA	NA	NA	NA
10	19	15	43%	1	3%	16	52%	17	61%	9	32%	2	7%	24	65%	10	32%	18	58%	3	10%	
10	19	15	43%	1	3%	16	50%	17	61%	9	32%	2	7%	24	65%	10	32%	18	58%	3	10%	
11	19	15	43%	1	3%	16	50%	17	61%	9	32%	2	7%	24	65%	10	32%	18	58%	3	10%	
11	NA	NA	NA	NA	NA	NA	NA	NA	NA	NA	NA	NA	NA	NA	NA	NA	NA	NA	NA	NA	NA	NA
11	NA	NA	NA	NA	NA	NA	NA	NA	NA	NA	NA	NA	NA	NA	NA	NA	NA	NA	NA	NA	NA	NA
11	NA	NA	NA	NA	NA	NA	NA	NA	NA	NA	NA	NA	NA	NA	NA	NA	NA	NA	NA	NA	NA	NA
11	NA	NA	NA	NA	NA	NA	NA	NA	NA	NA	NA	NA	NA	NA	NA	NA	NA	NA	NA	NA	NA	NA
11	NA	NA	NA	NA	NA	NA	NA	NA	NA	NA	NA	NA	NA	NA	NA	NA	NA	NA	NA	NA	NA	NA
11	NA	NA	NA	NA	NA	NA	NA	NA	NA	NA	NA	NA	NA	NA	NA	NA	NA	NA	NA	NA	NA	NA
11	NA	NA	NA	NA	NA	NA	NA	NA	NA	NA	NA	NA	NA	NA	NA	NA	NA	NA	NA	NA	NA	NA
11	NA	NA	NA	NA	NA	NA	NA	NA	NA	NA	NA	NA	NA	NA	NA	NA	NA	NA	NA	NA	NA	NA
11	NA	NA	NA	NA	NA	NA	NA	NA	NA	NA	NA	NA	NA	NA	NA	NA	NA	NA	NA	NA	NA	NA
11	NA	NA	NA	NA	NA	NA	NA	NA	NA	NA	NA	NA	NA	NA	NA	NA	NA	NA	NA	NA	NA	NA
11	NA	NA	NA	NA	NA	NA	NA	NA	NA	NA	NA	NA	NA	NA	NA	NA	NA	NA	NA	NA	NA	NA
11	NA	NA	NA	NA	NA	NA	NA	NA	NA	NA	NA	NA	NA	NA	NA	NA	NA	NA	NA	NA	NA	NA
11	NA	NA	NA	NA	NA	NA	NA	NA	NA	NA	NA	NA	NA	NA	NA	NA	NA	NA	NA	NA	NA	NA
11	NA	NA	NA	NA	NA	NA	NA	NA	NA	NA	NA	NA	NA	NA	NA	NA	NA	NA	NA	NA	NA	NA
11	NA	NA	NA	NA	NA	NA	NA	NA	NA	NA	NA	NA	NA	NA	NA	NA	NA	NA	NA	NA	NA	NA
11	NA	NA	NA	NA	NA	NA	NA	NA	NA	NA	NA	NA	NA	NA	NA	NA	NA	NA	NA	NA	NA	NA
11	NA	NA	NA	NA	NA	NA	NA	NA	NA	NA	NA	NA	NA	NA	NA	NA	NA	NA	NA	NA	NA	NA
11	NA	NA	NA	NA	NA	NA	NA	NA	NA	NA	NA	NA	NA	NA	NA	NA	NA	NA	NA	NA	NA	NA
11	NA	NA	NA	NA	NA	NA	NA	NA	NA	NA	NA	NA	NA	NA	NA	NA	NA	NA	NA	NA	NA	NA

Science, by Grade and Subgroup



DROPOUTS

Dropout Verification 2022-2023

Dropouts

Reflects Dropout Status of students reported by your District. Not all Students will be used in your District's dropout Calculations.

Criteria Used in Selecting Oct. 1 of previous year – Oct.2 of current year Dropouts:

Exit Date between Oct. 1 of previous year – Oct.2 of current year Inclusive
Grade Level 07-12

For more information on dropouts definition go [Here](#)

School	6	7	8	9	10	11	12	Total
Dunkerton Comm School District (0000)								
Dunkerton High School (0172)								

SRI Contact

Margaret Hanson 515-281-3214
Rachel Kuise 515-281-4153
Keri Ladelhoff 515-281-3805

Non-Public Contact

Jennifer Thomas 515-725-2252

Certification Status

[View](#)

Official State of Iowa Website

Agencies A-Z Programs & Services

Reporting Year: 2024

Dunkerton High School

[MORE DETAILS](#)

DUNKERTON COMM SCHOOL DISTRICT

CENTRAL RIVERS AEA

School Details:
Graduation Rate

Accountability View

This view provides information about the performance of students who are included in the accountability determinations.

GRADUATION RATE

What percent of the students graduate in four years? In five years?



4 YEARS

State Average: 87.46

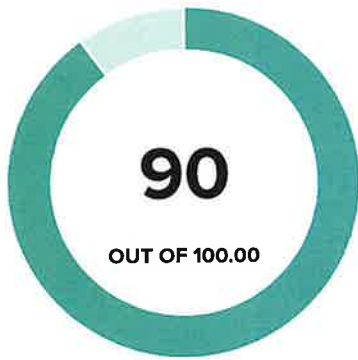

5 YEARS
State Average: 89.65

What does this score mean?

The 4-year graduation rate represents the percent of students who completed high school on-time within 4 years. The 5-year graduation rate shows the percent of students who needed an additional year to complete high school. The 4-year graduation rate shown is for the class of 2023, and the 5-year graduation rate is for the class of 2022.

Graduation Rate 4-Years

Percentage by Program

All Students: 32 out of 33 students

96.97

87.46

Low Socio-Economic Status (FRL): 21 out of 22 students

95.45

78.65

◆ **State Average**

Graduation Rate 5-Years

Percentage by Program

All Students: 36 out of 40 students



◆ State Average

Graduation Rate 4-Years

Percentage by Race

All Students: 32 out of 33 students



White: 26 out of 27 students



◆ State Average

Graduation Rate 5-Years

Percentage by Race

All Students: 36 out of 40 students



White: 31 out of 35 students



◆ State Average

Policy Notices

Official State of Iowa Website

Agencies A-Z Programs & Services

Reporting Year: 2024

Dunkerton High School

[MORE DETAILS](#)

DUNKERTON COMM SCHOOL DISTRICT

CENTRAL RIVERS AEA

ABOUT

Principal

Hannah Corbin

School Type

High

Enrollment

208

County

Black Hawk County

Grade Levels

06, 07, 08, 09, 10, 11, 12

OVERALL PERFORMANCE

COMMENDABLE

ESSA Support Category

No Support Required



State Average: 60.95%

Understanding Overall Performance

The overall performance includes both an overall score and performance rating for all Iowa schools across a number of performance measures. In addition, the Every Student Succeeds Act performance category identifies schools who are struggling or who have student groups who are underperforming. The overall score provides a single number which is the sum of the measures below. It provides a snapshot of school performance, but may not tell the entire story about performance of students in that school.

DEMOGRAPHICS

SHOW/HIDE

PERFORMANCE IN EACH AREA

Accountability View

Accountability view: This view provides information about the performance of students who are included in the accountability score (N \geq 20).

0 20 40



Post-secondary readiness index College Credit

Post-secondary readiness index Work-Based Learning

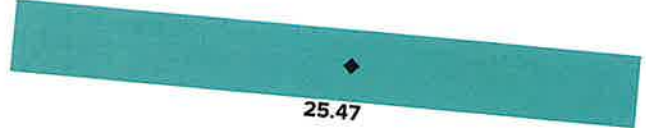

◆ State Average

PERFORMANCE DETAIL

Measure	Raw Score	Possible Points	Total Points
<u>Attendance Growth</u>	0.00	50.00	0.00
<u>Chronic Absenteeism</u>	39.25	50.00	30.38
<u>Graduation Rate 4-Years</u>	96.97	50.00	48.49
<u>Graduation Rate 5-Years</u>	90.00	50.00	45.00
<u>Growth English Language Arts</u>	59.00	150.00	88.50
<u>Growth Mathematics</u>	46.50	150.00	69.75
<u>Percent Proficient English Language Arts</u>	77.71	100.00	77.71
<u>Percent Proficient Mathematics</u>	72.29	100.00	72.29
<u>Percent Proficient Science</u>	65.52	100.00	65.52
<u>Post-secondary readiness index College Credit</u>	46.67	50.00	23.34
<u>Post-secondary readiness index Work-Based Learning</u>	86.67	50.00	43.34
			564.30 Total Points

Measure

	Raw Score	Possible Points	Total Points
			62.70% of possible Points

**Summing the Possible Points column may not equal 100 due to rounding calculations.*

Policy Notices